

8.0 Recreation and Open Space Element

PURPOSE

The purpose of this element is to ensure the provision of adequate and accessible recreation facilities and open space to meet the future needs of the University.

(1) DATA REQUIREMENTS. This element shall be based, at a minimum, on the following data:

a) An inventory of all existing privately owned, state-owned, or local government-owned recreational facilities and open spaces within the context area. The following shall be identified for each site:

1. The types of uses provided (activity based or resource based);
2. The types of recreation facilities (ballfields, courts, etc.) provided;
3. The estimated usage at each site (frequency and number of people); and
4. The total acreage at each site.

Information on estimated usage at each site is not available. However, each of the facilities assists the city in meeting its adopted level-of-service standards for recreation and open space.

Table 8.1 Recreational Facilities within the FAMU Service Area

Facility	Facility Uses	Total Acreage
Boulevard Park	Open space	.72 acres
Cascades Park	Open space/Trail/Playground/Picnic	24 acres
Capital Cascades Trail	Open space/Trail/Playground/Picnic	NA
Coal Chute Park	Open space	1.3 acres
Country Club Park	Open space/ Ballfields	3.5 acres
Jack L. McLean Jr. Park Center Pool	Open space/Swimming/Playground/Picnic/Ball Courts/Trails	52 acres
Jake Gaither Community Center	Multi-purpose center/Open space/Playground/Picnic/Ball Courts/Ballfield/Golf	118.9 acres
Lake Elberta Park	Open area/Trail	~30 acres
Myers Park	Open space/Trail/Playground/Ball Courts	24.8 acres
Pearlie Mae Butler Playground	Playground	.48 acres
Speed-Spencer-Stephens Park	Open space/Trail	2.4 acres
Springsax Park	Ballfields/picnic	35.4 acres
Wade Wehunt Pool	Swimming	1.25 acres
Walker-Ford Center	Swimming/Ballcourts/Ballfield	12.4 acres

Source: Tallahassee Parks and Recreation Department, Tallahassee/Leon County GIS, 2015

b) An inventory of the University-owned or managed recreation sites, open spaces, incidental recreation facilities, parks, lakes, forests, reservations, freshwater or saltwater beaches (map, narrative and tabular) identifying:

1. The estimated usage at each site (frequency and number of people);
2. The total acreage at each site or facility.

See Figures 8.1A and 8.1B: Campus Recreational Facilities for locations.

Table 8.2 Inventory of all University-owned Athletic Facilities

Facility	Estimated Usage	Total Acreage
Baseball (Men's Intercollegiate)	-	4.0
Baseball (2 Fields; Intramural)	-	4.74
Basketball (Men's Intercollegiate)	-	6.7
Basketball (Women's Intercollegiate)	-	6.7
Basketball (5 Courts; Intramural)	-	0.57
Basketball (2 Courts; DRS)	-	0.27
Bowling (7 Lanes)	-	NA
Football (Men's Intercollegiate)	-	12.59
Football (1 Field; DRS)	-	1.44
Flag Football (Intramural)	-	2.29
Golf	-	NA
Racquetball (4 Courts)	-	0.3
Recreation Center	-	4.27
Soccer (1 Field; Intramural)	-	1.86
Softball (Women's Intercollegiate)	-	2.10
Softball (2 Fields; Intramural)	-	2.97
Swimming	-	0.64
Tennis (16 courts)	-	2.15
Track and Cross Country	-	3.71
Volleyball (3 Courts)	-	0.17
Wrestling	-	NA

* At the time this report was prepared FAMU was in the process of collecting and updating estimated usage data. The multi-purpose teaching gymnasium serves both men's and women's intercollegiate basketball; Men's intercollegiate football includes the practice field; and FAMU Developmental Research School recreation facilities are included in the above table.

Source: Wood+Partners Inc, 2017

c) A description of the level of service standard(s) established by the host community for each type of recreation facility described in the Comprehensive Plan of the jurisdiction.

The Recreation Element of the Tallahassee-Leon County Comprehensive Plan establishes a system comprised of three different levels of parks with the following minimum level of service acreage standards measured in acres per 1,000 persons.

Table 8.3 Recreation Facilities Level of Service per 1,000 Population

Responsible Government	Countywide	Area	Local (Recommended)
City	4	1 Acre	2
County	8	1 Acre	---
Federal/State	4	---	---

Source: Tallahassee-Leon County 2030 Comprehensive Plan (as of 2015 Out of Cycle Amendments)

d) A description of any University-owned recreational facilities or open spaces that have been incorporated in the Recreation and Open Space Element of the host community’s Comprehensive Plan.

The Future Land Use Map of the Tallahassee-Leon County Comprehensive Plan classifies the FAMU property entirely as Education Facility. Therefore, none of the existing recreation or open spaces on campus have been incorporated into the comprehensive plan.

(2) ANALYSIS REQUIREMENTS. This element shall be based, at a minimum, on the following analyses:

a) An analysis of the projected needs for recreation and open space facilities required to meet the needs of the future University population (students, faculty and staff) based on University standards and calculations or established level of service standards.

Based on the standards established by the host community for Local Level of Service standards (Table 8.3), the campus will need to maintain a level of at least two (2) acres of open recreation space per 1,000 students. Based upon projected student enrollment and current levels of open space, the University will maintain the level of service through the planning period.

b) An assessment of the adequacy of the existing recreational facilities and open spaces to meet the projected needs of the University (on campus, off campus), including a description of the extent to which off-campus facilities may meet some or all of the University projected needs.

The University has ensured adequate provisions for recreational facilities and open spaces that meet the needs of the student population through the completion of facilities in previous years. Opportunities do exist for enhancement of open spaces including the creation of quadrangles, squares, and plaza spaces that promote social interaction. Passive trail opportunities exist within the open space and conservation areas of campus.

A substantial facility problem does exist in the swimming pool. Due to its deteriorated condition the pool, was closed in 2006. The smaller training pool was renovated in 2013, yet the larger pool remains closed. Consideration should be given to assessing the need for renovating the larger pool in terms of recreational services provided for the campus.

Off-campus recreational facilities are not required to meet the University's projected needs. However the University currently benefits from the proximity of numerous passive and active recreational facilities nearby.

c) An assessment of opportunities for alternative future facility siting in order to conserve the supply and character of campus open space.

The campus master plan update contemplates a significant reorganization of collegiate football facilities from their current location to the southern portion of campus along with the relocation of the track and field facility and intramural fields to the current site of Bragg Stadium. This rearrangement of athletic and recreational facilities makes provisions for new and enhanced campus open spaces that will further define the character of campus through the creation of linear greens, an amphitheater, and passive walking trails.

d) An analysis of planned future recreation and open space facilities, as adopted by the host community in their Comprehensive Plan or other best available data.

Complementing the recently completed segment of FAMU Way and Capital Cascades trail, additional segments are either in the construction or design phase. Upon completion, the Capital Cascades Trail will connect from Cascades Park to St. Marks. This trail system connects to a wide range of recreation and open space amenities that offer the University a diverse set of experiences.



- 001 - LEE HALL
- 002 - JACKSON DAVIS HALL
- 003 - UNIVERSITY COMMONS
- 005 - N.B. YOUNG HALL
- 006 - S.B.I. / SOUTH WING
- 007 - CARNEGIE CENTER
- 008 - LUCY MOTEN
- 009 - WARE / RHANEY BUILDING
- 010 - TRACK & FIELD TOWER
- 011 - ATHLETIC STORAGE BUILDING
- 012 - GEORGE CONOLY GREENHOUSE
- 013 - PRESIDENT'S HOUSE
- 014 - TUCKER HALL
- 015 - HONOR HOUSE
- 016 - SCHOOL OF ARCHITECTURE
- 018 - MAIN GARAGE
- 017 - INTERNATIONAL LANGUAGE
- 019 - ENVIRONMENTAL SCIENCES INST.
- 021 - GAITHER GYMNASIUM

- 022 - GAITHER OFFICE & CLASSROOM
- 023 - L.S. BARTLEY ATHLETIC COMPLEX
- 024 - UNIVERSITY SOFTBALL DUGOUT
- 025 - HAZARDOUS STORAGE
- 026 - UNIVERSITY BASEBALL DUGOUT
- 029 - RECREATION CENTER
- 030 - USDA TELECONFERENCE CENTER
- 031 - DAIRY BARN AND WINERY
- 032 - M.S. THOMAS INDUSTRIAL ARTS LAB
- 034 - CONTINUING EDUC. CONF. CENTER
- 035 - UNIVERSITY BAND STORAGE
- 036 - S.B.I. / WEST & NORTH
- 037 - CONTINUING EDUCATION
- 038 - CENTRAL CHILLED WATER PLANT
- 040 - SCHOOL OF JOURNALISM
- 041 - UNIVERSITY ACTIVITIES CENTER
- 042 - COUNSELING CENTER
- 043 - MCGUINN HALL
- 044 - TRUTH HALL

- 046 - CROPPER HALL
- 047 - DIAMOND HALL
- 048 - SAMPSON HALL
- 049 - COLEMAN LIBRARY
- 050 - S.B.I. / EAST WING
- 052 - CENTRAL HEAT PLANT
- 054 - FOOTE / HILYER ADMIN. CENTER
- 055 - JONES HALL
- 056 - SCIENCE RESEARCH FACILITY
- 057 - CNTR FOR EQUITY & CULT. DIVERSITY
- 058 - HOWARD HALL
- 059 - GIBBS HALL
- 061-066 - OLD D.R.S.
- 067 - GENERAL CLASSROOM
- 068 - FOSTER-TANNER CERAMIC CENTER
- 069 - FOSTER-TANNER MUSIC CENTER
- 070 - FOSTER-TANNER ART CENTER
- 071 - GORE EDUCATION COMPLEX
- 072 - D.R.S. GYM

- 073 - FOSTER-TANNER BAND BUILDING
- 074 - DYSON PHARMACY
- 075 - COLLEGE OF PHARMACY
- 076 - SMALL ANIMAL LAB
- 078 - F&P
- 079 - UNIVERSITY PARKING SERVICES(M)
- 080-082 - P.O.M. BUILDINGS A-C
- 083 - P.O. HAZARDOUS STORAGE-A
- 084 - P.O. HAZARDOUS STORAGE-B
- 086 - P.O. MECH. CHILLER
- 087 - P.O.M. STORAGE
- 088 - ATHLETICS ACADEMICS
- 089 - LEARNING DEVELOPMENT EDUC. CENTER
- 090 - (M)
- 092 - TITLE THREE-FGMP(M)
- 093 - UNIVERSITY PARKING SERVICES / INFO
- 094 - FOSTER-TANNER OBSERVATION TOWER
- 096 - S.B.I. (M) I
- 097 - S.B.I. (M) II

- 103 - PHYSICAL PLANT STORAGE-A
- 104 - PHYSICAL PLANT TRANSITION CENTER
- 111-114 - BENJAMIN BANNEKER BLDGS A-D
- 115-118 - PADDYFOOTE COMPLEX A-D
- 124 - GIBBS COTTAGE
- 131-133 - SCHOLARSHIP HOUSES
- 134 - CHILDCARE CENTER
- 135 - D.R.S. HEALTH
- 136-151 - POLKINGHORNE VILLAGE APTS.
- 152-160 - PALMETTO STREET APARTMENTS
- 161 - WILLIAM GRAY, JR. PLAZA
- 162-164 - PALMETTO HOUSING PHASE III
- 165-167 - OLD D.R.S.
- 170 - STUDENT SERVICES CENTER
- 171 - PARKING GARAGE I
- 200 - EVENING AND WEEKEND COLLEGE
- 201 - D.R.S. CAREER
- 202 - COMM. DEVELOPMENT PROGRAM
- 203 - FAMU UNDERGRAD PROGRAM

- 204 - A&S ELECTRONIC CLASSROOM
- 205 - SCHOOL OF ARCHITECTURE
- 206 - POLICE STORAGE
- 300 - BRAGG STADIUM
- 305 - GALIMORE-POWELL ATHLETIC FIELD HOUSE
- 315 - MULTI-PURPOSE GYMNASIUM
- 561-562 - PERRY-PAIGE BUILDING
- 601-604 - STUDENT UNION COMPLEX
- 605-608 - SOUTH PALMETTO BLDG A-D
- 609 - S. PALMETTO COMMONS BLDG-E
- 610 - S. PALMETTO COMMONS BLDG-F
- 701 - NEW D.R.S. GYMNASIUM
- 702 - NEW D.R.S. ADMIN. BUILDING
- 703 - NEW D.R.S. ELEMENTARY SCHOOL
- 704 - NEW D.R.S. CAFETERIUM
- 705 - NEW D.R.S. MIDDLE SCHOOL
- 706 - NEW D.R.S. HIGH SCHOOL

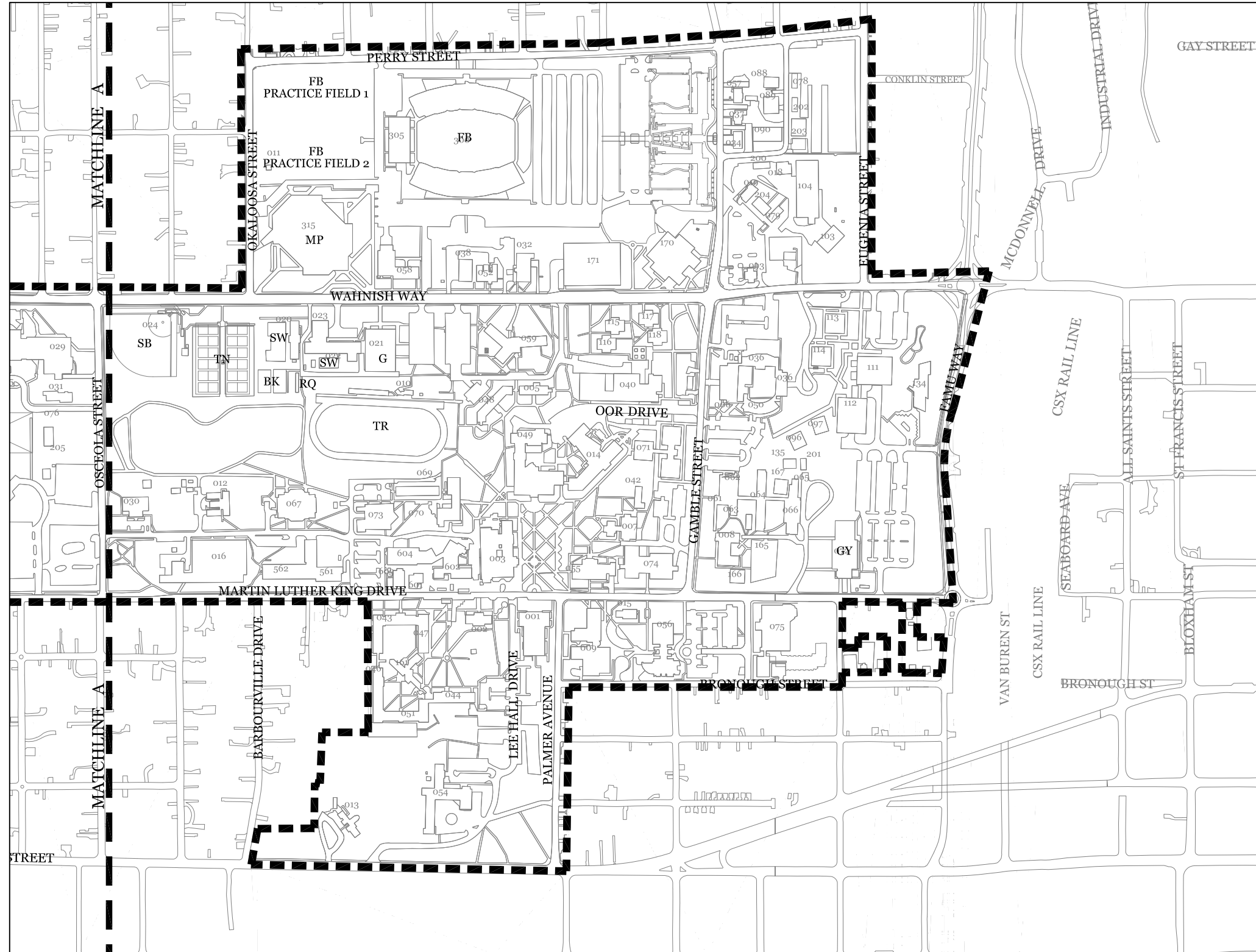

RECREATIONAL FACILITIES MAP (NORTH)

LEGEND:

UNIVERSITY BASEBALL FIELD*	RECREATION SOFTBALL FIELD
BASKETBALL COURT	RECREATION SOCCER FIELD
DRS BASKETBALL COURT	MARCHING 100 PRACTICE FIELD
DRS FOOTBALL FIELD	MULTI-PURPOSE TEACHING GYMNASIUM*
DRS SOFTBALL FIELD	RACQUETBALL COURT
DRS TENNIS COURT	MULTI-PURPOSE RECREATION CENTER
BRAGG STADIUM*	UNIVERSITY SOFTBALL FIELD*
GAITHER GYMNASIUM	SWIMMING POOL
OLD DRS GYMNASIUM	TENNIS COURT
RECREATION BASEBALL FIELD	ROBERT "PETE" GRIFFIN TRACK AND FIELD*
RECREATION BASKETBALL COURT	VOLLEYBALL COURT
RECREATION FLAG FOOTBALL FIELD	

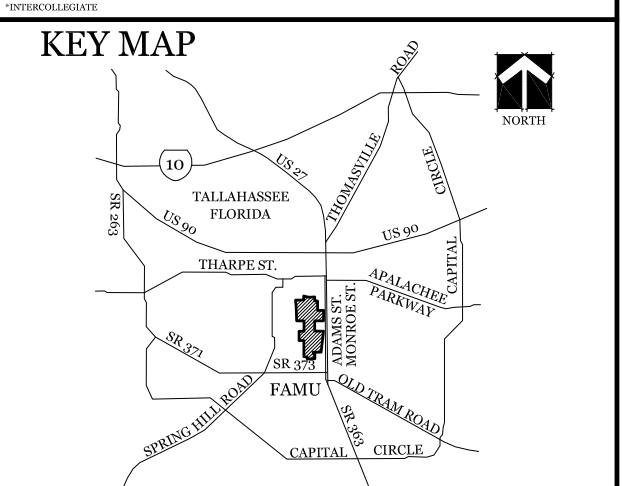

2015-2025 MASTER PLAN INVENTORY & ANALYSIS
FLORIDA A&M UNIVERSITY
 TALLAHASSEE, FLORIDA
 DATE: JANUARY 2018

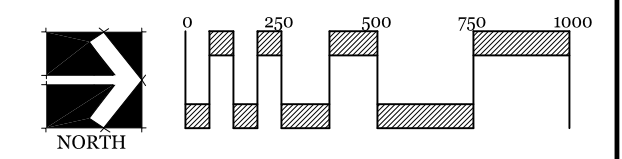



001 - LEE HALL
 002 - JACKSON DAVIS HALL
 003 - UNIVERSITY COMMONS
 005 - N.B. YOUNG HALL
 006 - S.B.I. / SOUTH WING
 007 - CARNEGIE CENTER
 008 - LUCY MOTEN
 009 - WARE / RHANEY BUILDING
 010 - TRACK & FIELD TOWER
 011 - ATHLETIC STORAGE BUILDING
 012 - GEORGE CONOLY GREENHOUSE
 013 - PRESIDENT'S HOUSE
 014 - TUCKER HALL
 015 - HONOR HOUSE
 016 - SCHOOL OF ARCHITECTURE
 018 - MAIN GARAGE
 017 - INTERNATIONAL LANGUAGE
 019 - ENVIRONMENTAL SCIENCES INST.
 021 - GAITHER GYMNASIUM

022 - GAITHER OFFICE & CLASSROOM
 023 - L.S. BARTLEY ATHLETIC COMPLEX
 024 - UNIVERSITY SOFTBALL DUGOUT
 025 - HAZARDOUS STORAGE
 026 - UNIVERSITY BASEBALL DUGOUT
 029 - RECREATION CENTER
 030 - USDA TELECONFERENCE CENTER
 031 - DAIRY BARN AND WINERY
 032 - M.S. THOMAS INDUSTRIAL ARTS LAB
 034 - CONTINUING EDUC. CONF. CENTER
 035 - UNIVERSITY BAND STORAGE
 036 - S.B.I. / WEST & NORTH
 037 - CONTINUING EDUCATION
 038 - CENTRAL CHILLED WATER PLANT
 040 - SCHOOL OF JOURNALISM
 041 - UNIVERSITY ACTIVITIES CENTER
 042 - COUNSELING CENTER
 043 - MCGUINN HALL
 044 - TRUTH HALL

046 - CROPPER HALL
 047 - DIAMOND HALL
 048 - SAMPSON HALL
 049 - COLEMAN LIBRARY
 050 - S.B.I. / EAST WING
 052 - CENTRAL HEAT PLANT
 054 - FOOTE / HILYER ADMIN. CENTER
 055 - JONES HALL
 052 - SCIENCE RESEARCH FACILITY
 057 - CNTR FOR EQUITY & CULT. DIVERSITY
 058 - HOWARD HALL
 059 - GIBBS HALL
 061-066 - OLD D.R.S.
 067 - GENERAL CLASSROOM
 068 - FOSTER-TANNER MUSIC CENTER
 069 - FOSTER-TANNER CERAMIC CENTER
 070 - FOSTER-TANNER ART CENTER
 071 - GORE EDUCATION COMPLEX
 072 - D.R.S. GYM

073 - FOSTER-TANNER BAND BUILDING
 074 - DYSON PHARMACY
 075 - COLLEGE OF PHARMACY
 076 - SMALL ANIMAL LAB
 078 - F&P
 079 - UNIVERSITY PARKING SERVICES(M)
 080-082 - P.O.M. BUILDINGS A-C
 083 - P.O. HAZARDOUS STORAGE-A
 084 - P.O. HAZARDOUS STORAGE-B
 086 - P.O. MECH. CHILLER
 087 - P.O.M. STORAGE
 088 - ATHLETICS ACADEMICS
 089 - LEARNING DEVELOPMENT EDUC. CENTER
 090 - (M)
 092 - TITLE THREE-FGMP(M)
 093 - UNIVERSITY PARKING SERVICES / INFO
 094 - FOSTER-TANNER OBSERVATION TOWER
 096 - S.B.I. (M) I
 097 - S.B.I. (M) II

103 - PHYSICAL PLANT STORAGE-A
 104 - PHYSICAL PLANT TRANSITION CENTER
 111-114 - BENJAMIN BANNKER BLDGS A-D
 115-118 - PADDYFOOTE COMPLEX A-D
 124 - GIBBS COTTAGE
 131-133 - SCHOLARSHIP HOUSES
 134 - CHILDCARE CENTER
 135 - D.R.S. HEALTH
 136-151 - POLKINGHORNE VILLAGE APTS.
 152-160 - PALMETTO STREET APARTMENTS
 161 - WILLIAM GRAY, JR. PLAZA
 162-164 - PALMETTO HOUSING PHASE III
 165-167 - OLD D.R.S.
 170 - STUDENT SERVICES CENTER
 171 - PARKING GARAGE I
 200 - EVENING AND WEEKEND COLLEGE
 201 - D.R.S. CAREER
 202 - COMM. DEVELOPMENT PROGRAM
 203 - FAMU UNDERGRAD PROGRAM

204 - A&S ELECTRONIC CLASSROOM
 205 - SCHOOL OF ARCHITECTURE
 206 - POLICE STORAGE
 300 - BRAGG STADIUM
 305 - GALIMORE-POWELL ATHLETIC FIELD HOUSE
 315 - MULTI-PURPOSE GYMNASIUM
 561-562 - PERRY-PAIGE BUILDING
 601-604 - STUDENT UNION COMPLEX
 605-608 - SOUTH PALMETTO BLDG A-D
 609 - S. PALMETTO COMMONS BLDG-E
 610 - S. PALMETTO COMMONS BLDG-F
 701 - NEW D.R.S. GYMNASIUM
 702 - NEW D.R.S. ADMIN. BUILDING
 703 - NEW D.R.S. ELEMENTARY SCHOOL
 704 - NEW D.R.S. CAFETERIUM
 705 - NEW D.R.S. MIDDLE SCHOOL
 706 - NEW D.R.S. HIGH SCHOOL

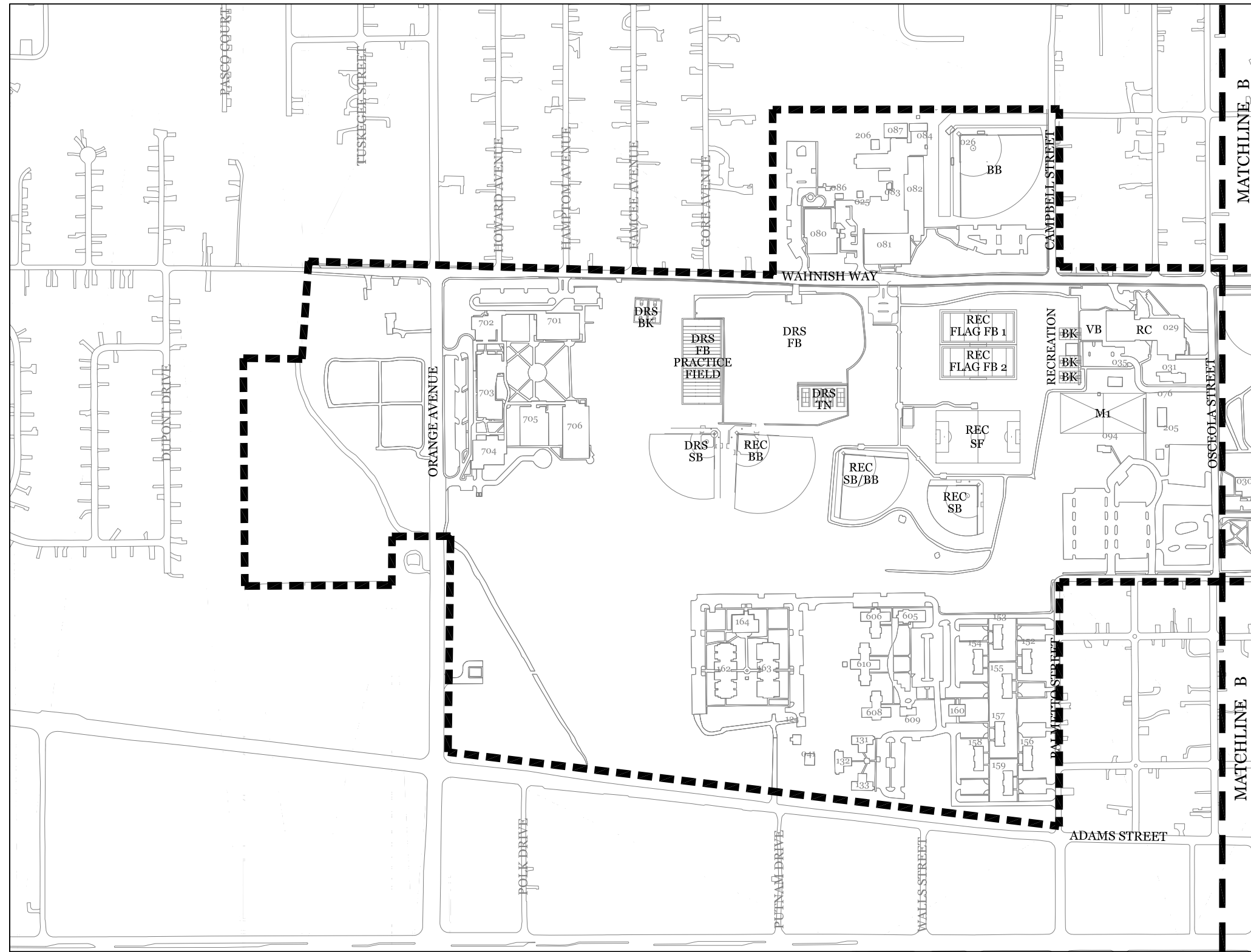

RECREATIONAL FACILITIES MAP (SOUTH)

LEGEND:

- | | |
|--------------------------------|--|
| UNIVERSITY BASEBALL FIELD* | RECREATION SOFTBALL FIELD |
| BASKETBALL COURT | RECREATION SOCCER FIELD |
| DRS BASKETBALL COURT | MARCHING 100 PRACTICE FIELD |
| DRS FOOTBALL FIELD | MULTI-PURPOSE TEACHING GYMNASIUM* |
| DRS SOFTBALL FIELD | RACQUETBALL COURT |
| DRS TENNIS COURT | MULTI-PURPOSE RECREATION CENTER |
| BRAGG STADIUM* | UNIVERSITY SOFTBALL FIELD* |
| GAITHER GYMNASIUM | SWIMMING POOL |
| OLD DRS GYMNASIUM | TENNIS COURT |
| RECREATION BASEBALL FIELD | ROBERT "PETE" GRIFFIN TRACK AND FIELD* |
| RECREATION BASKETBALL COURT | VOLLEYBALL COURT |
| RECREATION FLAG FOOTBALL FIELD | |

*INTERCOLLEGIATE

KEY MAP

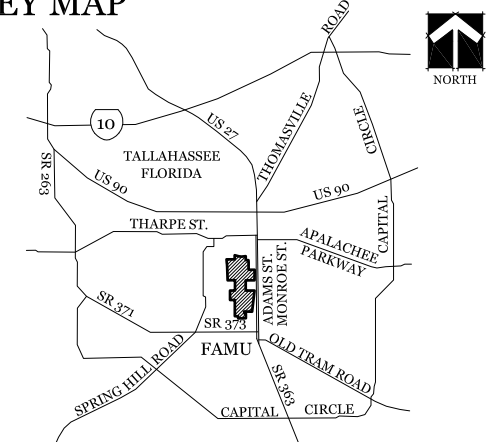

2015-2025 MASTER PLAN INVENTORY & ANALYSIS
 FLORIDA A&M UNIVERSITY
 TALLAHASSEE, FLORIDA

DATE: JANUARY 2018

